

## JACE NiMH Replacement Battery (NPB-XPR-BATT) INSTALL SHEET

This document covers the replacement of the NiMH battery pack assembly (NPB-XPR-BATT) in a Vykon® J-202 / J-602 Express or M2M JACE controller.

**Table 1 NPB-XPR-BATT description.**

Description	Notes
Custom 12V NiMH (Nickel Metal Hydride) battery pack assembly with two-wire cable and connector plug, pre-mounted on a metal "H-bracket" with three mounting holes.	<p>Replacement requires powering off the JACE controller, removing its covers, and unscrewing the old battery pack assembly.</p> <p>Before replacing the battery, be sure to backup the JACE's configuration, using the appropriate NiagaraAX software tool (e.g. Workbench platform tools).</p> <p>Note that a new replacement NiMH battery may require up to 18 hours of powered operation before it will reach full charge and provide reliable power backup.</p>

For related JACE® mounting and wiring details (including battery operation), see the appropriate JACE mounting and wiring document.

### Included in this Package

Included in this package you should find the following items:

- an NPB-XPR-BATT assembly.
- This *JACE NiMH Replacement Battery (NPB-XPR-BATT) Install Sheet*, Part Number 11827 Rev 1.

### Material and Tools Required

The following tool is required for installation:

- #1 and #2 phillips screwdrivers: used to remove the two JACE covers, and to remove the old NiMH battery assembly and re-mount the new NPB-XPR-BATT assembly.

**Figure 1 NPB-XPR-BATT assembly.**

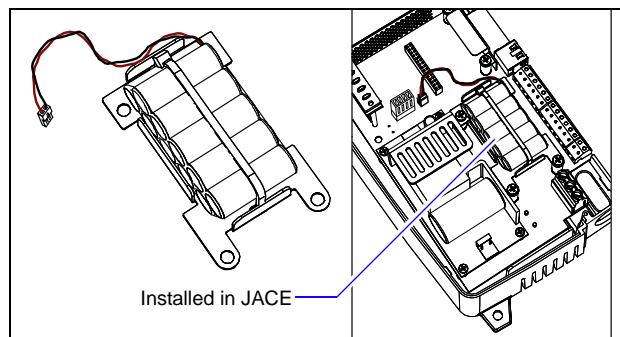

### Mounting



**Warning** Power to the JACE must be OFF when removing the old NiMH battery assembly and replacing with the NPB-XPR-BATT.

The NPB-XPR-BATT assembly replaces the original NiMH battery assembly in the JACE controller.

#### Procedure 1 Mounting NPB-XPR-BATT in JACE.

1. Backup the JACE controller's configuration to your PC using the appropriate NiagaraAX software tool (for example, Workbench).
2. If a 12V sealed lead-acid backup battery is attached, disconnect it from the controller.
3. Remove power from the JACE—see the previous **Warning** above. Wait for LED activity to stop—after several seconds, all LEDs on the JACE should be off.
4. Remove the JACE covers, using a #1 Phillips screwdriver, carefully retaining the screws.
  - a. Remove the two screws holding the right cover first. Slide the cover towards the right to disengage. See **Figure 2** on page 2.
  - b. Remove the two screws holding the left cover next. Lift the cover away from the unit, revealing the NiMH battery pack.

Information and/or specifications published here are current as of the date of publication of this document. Tridium, Inc. reserves the right to change or modify specifications without prior notice. The latest product specifications can be found by contacting our corporate headquarters, Richmond, Virginia. Products or features contained herein are covered by one or more U.S. or foreign patents. This document may be copied by parties who are authorized to distribute Tridium products in connection with distribution of those products, subject to the contracts that authorize such distribution. It may not otherwise, in whole or in part, be copied, photocopied, reproduced, translated, or reduced to any electronic medium or machine-readable form without prior written consent from Tridium, Inc. Complete confidentiality, trademark, copyright and patent notifications can be found at: <http://www.tridium.com/galleries/SignUp/Confidentiality.pdf>. © 2010 Tridium, Inc.

JACE, Niagara Framework, Niagara AX Framework and the Sedona Framework are trademarks of Tridium, Inc.

JACE NiMH Replacement Battery (NPB-XPR-BATT) Install Sheet

Part Number 11827 Rev 1

Published: March 31, 2010

**Figure 2 Remove right cover then left cover.**

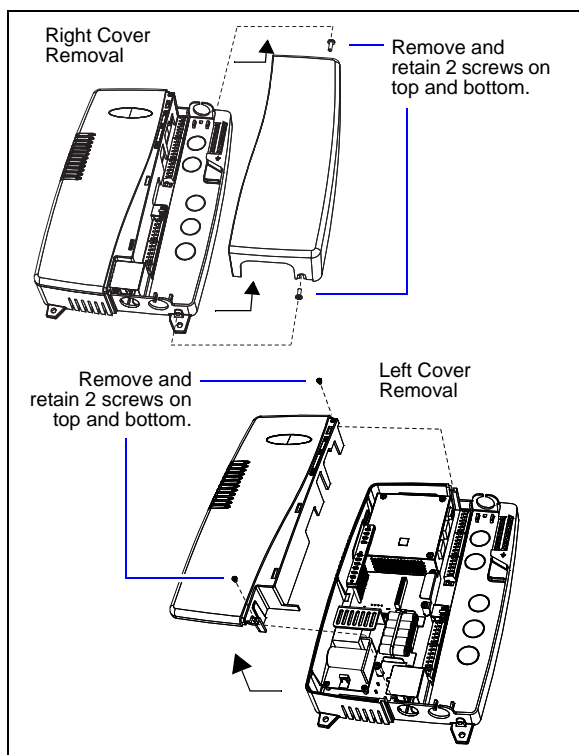

5. Unplug the NiMH battery from the main board connector (see [Figure 3](#) for location).

**Figure 3 Battery connector and 3 mounting screws.**

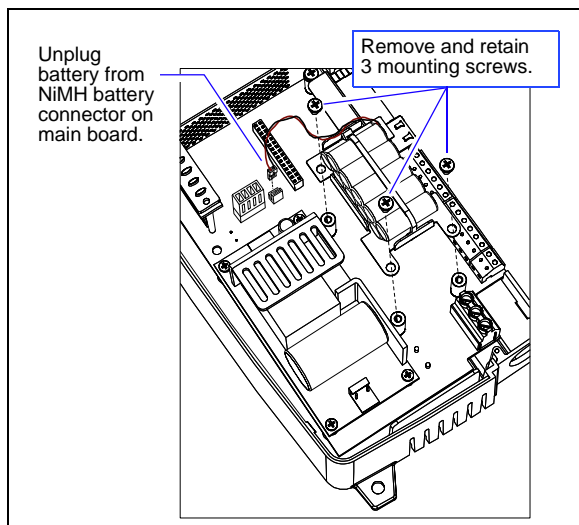

6. Remove the three Phillips head screws fastening the battery bracket, and set aside. Remove the NiMH battery assembly.

7. Plug the battery connector plug of the replacement battery assembly into the NiMH battery connector on the controller's main board. The connector is keyed—you cannot plug the battery in reversed.
8. Set the replacement battery/bracket assembly in place, with the three mounting holes aligned with the standoffs on the controller board.

**Figure 4 Re-fasten screws through battery bracket.**

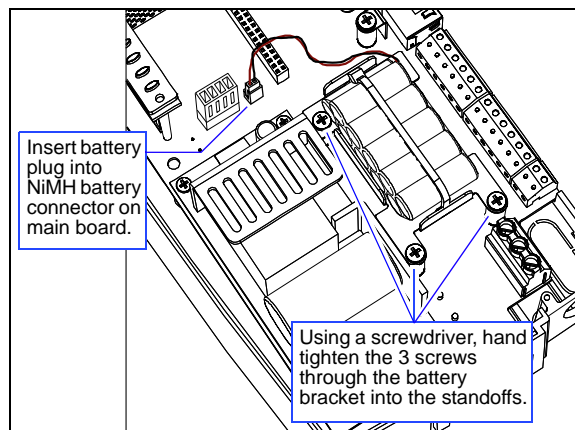

9. Place the three screws through the holes in the bracket and into the standoffs. Using a Phillips head screwdriver, hand tighten these screws.
10. If a 12V sealed lead-acid backup battery was disconnected, reconnect it to the controller.
11. Replace the JACE covers, using the screws previously retained. Replace the left cover first, then the right cover.

## Battery Disposal

Please dispose of the used JACE NiMH battery in accordance with local, state, and federal regulations.



**Warning** Do not incinerate or mutilate the battery, as this may cause it to burst or release toxic materials.

If regulations specify returning the old battery to a recycling center, but no acceptable recycling center can be found, please return the old JACE NiMH battery pack to Tridium for proper disposal.